



# *Street*Strider

The Elliptical that **MOVES** You!

**Eclipse / JET For Kids**  
**OWNER'S MANUAL**

## OWNER'S MANUAL CONTENTS

## PAGE

1. About This Manual	3
2. Hardware	4
A. Parts Identification	4
B. Hardware List	6
3. Unpacking and Assembly	8
A. Eclipse	8
B. JET	11
4. Simple Steps to Learn to Stride	14
5. Safety Equipment	14
6. Mechanical Safety Check	16
7. Limited Warranty	16
8. Return Policy	18

## RECORDS

Please record your *StreetStrider* model name (Eclipse or JET), serial number (stamped on the head tube beneath the quick release fold joint) and other information below in this manual. Please retain your sales receipt as proof of purchase and keep with the information below.

MODEL NAME \_\_\_\_\_  
SERIAL NUMBER \_\_\_\_\_  
DATE OF PURCHASE \_\_\_\_\_  
PLACE OF PURCHASE \_\_\_\_\_

Also, please register your *StreetStrider* online at [www.streetstrider.com](http://www.streetstrider.com) so that we can notify you about new models and release dates and care and maintenance issues, and so that we will have a record of your serial number and purchase date. You may also want to register your serial number with your local police department in the event that your *StreetStrider* is lost or stolen.

# 1. About This Manual

This *Eclipse and JET Owner's Manual* contains important assembly, maintenance, safety and performance information. It was written to help you get the most performance, comfort, enjoyment and safety out of your new *StreetStrider*. Keep this manual handy for future reference.

**IMPORTANT:** If your *StreetStrider* was purchased unassembled, you should read this manual before you assemble it. The Limited Warranty found on page 16 applies only to *StreetStriders* that have been assembled in full compliance with the instructions in this Owner's Manual.

**IMPORTANT:** You should read this manual before go out on your first ride.

Riding a *StreetStrider* can be a hazardous activity even under the best of circumstances. It is highly recommended that your first ride on your new *StreetStrider* be taken in a controlled environment, away from cars, obstacles and other cyclists, and wearing your helmet.

Proper maintenance of your *StreetStrider* is your responsibility as it helps reduce the risk of injury. This manual contains many **IMPORTANT**, **CAUTION** and **WARNING** statements concerning the consequences of failure to maintain or inspect your *StreetStrider*. When inspecting your *StreetStrider*, be certain to tighten all nuts and bolts properly. Under-tightening can result in loosening, parts loss, and component damage. Over-tightened nuts and bolts can break. *StreetStrider* parts have metric hardware--always use the correct tools.

**IMPORTANT:** Failing to read and comply with all assembly, safety, performance and maintenance requirements and warnings as well as unsafe or improper use of the *StreetStrider* could result in serious injury or death. It is also impossible to predict every situation and condition that will occur while *StreetStriding*. *StreetStrider* International LLC (the Company) has made no representation about the safe use of the *StreetStrider* under all conditions. There are risks associated with the use of any *StreetStrider* that cannot be predicted or avoided, and the Company recommends safe and cautious riding.

**NOTE:** Please check the website [www.streetstrider.com](http://www.streetstrider.com) for the latest information about our products and services.

## 2. Hardware – A. Parts Identification

The parts of the *StreetStrider Eclipse* are listed and labeled in the following table and figures. The parts of the *StreetStrider JET* (not shown) are identical to the Eclipse.

Table 2A-1. *StreetStrider* Parts List. Parts are numbered in subsequent figures.

PART NUMBER	PART DESCRIPTION
1	Main frame
2	Head tube
3	Crossbar
4	Front beam
5	Fold joint, quick release
6	Strider pole, upper
7	Strider pole, lower
8	Strider ski, left
9	Strider ski, right, telescoping quick release
10	Foot platform
11	Seat stay
12	Chain stay
13	Rear wheel fender
14	Pivot joint #1, 6 mm hex screw
15	Pivot joint #2, 6 and 5 mm hex screws
16	Pivot joint #3, 8 mm hex screw
17	Hand grip
18	Brake lever
19	Rear cantilever brake
20	Strider pole adjuster, quick release
21	Front wheel
22	Front wheel hub, 19 mm axle bolt nuts
23	Steering linkage, 14 mm jam nuts
24	Crank arm, 8 mm hex screw
25	Rear wheel
26	Chainless internal gear hub
27	Brake lever locking pin
28	Brake cable adjuster
29	Brake lever locking pin
30	Reflector
31	Bottle cage
32	Front beam pivot, 8 mm hex screw
33	Rod end, LH thread inboard and RH thread outboard
34	Velcro wrapping strap
35	Axle bolt with 19 mm lock nuts
36	King pin bolt with 19 mm lock nut
37	Steering arm clamped to king pin with 3 mm hex screw
38	Steering stop screw, 10 mm head and jam nut
39	Brake pad adjuster screw, 5 mm hex
40	Fender mounting screws, 4 mm hex
41	Drop out
42	Drop out lock plate, 4 mm hex screws
43	Crank bolt, 8 mm hex
44	Bumper for folded cross bar
45	Telescoping ski lock pin locations

Figure 2A-1. StreetStrider Eclipse Parts. Refer to Table 2A-1 for part numbers and descriptions.



## 2. Hardware – B. Hardware List

The hardware parts of the *StreetStrider Eclipse* are listed and labeled in the following table and figures. The hardware parts of the *StreetStrider JET* (not shown) are identical to the Eclipse.

Table 2B-1. *StreetStrider Eclipse* Hardware List. Hardware parts are lettered in the following figure.

Dimension	M=OD of threads, mm	L=length	W=wrench fit, mm
Key	P=pitch, threads/mm	H=OD of head	T=washer thickness, mm

ITEM	BOLTS, SCREWS, NUTS, WASHERS	DIMENSIONS	#	MAINTENANCE ROUTINE
A	Hex bolt on strider pole pivot, joint #1	M6 x P1.25 x L20 x H12 x W6	2	Tighten
B	Washer under bolt on joint #1	OD25 x ID9 x T2	2	
C	Hex barrel on lower strider pole clevis, joint #2	M6 x P1.0 x L50 x H14 x W6	2	Snug but allow joint movement
D	Screw for hex barrel on joint #2	M5 x P1.0 x L12 x W5	2	Snug but allow joint movement
E	Hex shoulder bolt pedal spindle, joint #3	M8 x P9/16" x L50 x H25 x W8, 18 mm OD shoulder	2	Tighten, left LH, right RH
F	Hex bolt on crank arm and hub spindle	M8 x P1.0 x L15 x H12 x W8, 18 mm flange	2	Tighten
G	Bolt through steering knuckle, king pin	M12 x P1.5 x L105 x H25	2	Snug but allow knuckle swivel
H	Nut for king pin	M12 x P1.5 x L12 x W19, nylon lock	2	Snug but allow knuckle swivel
I	Washer under nut of king pin	OD24 x ID13 x T1	2	
J	Hex barrel for head tube fold joint pivot	M5 x P1.0 x L60 x H12 x W5	1	Tighten
K	Screw for hex barrel of fold joint	M5 x P1.0 x L12 x H12 x W5	1	Tighten
L	Hex bolt as turning stopper on front beam	M5 x P1.0 x L25 x H10 x W10	2	Tighten
M	Nut for turning stopper bolt	M5 x P1.0 x L5 x W10	2	Tighten
N	Nut for rod end stud, inboard and outboard	M8 x P1.5 x L10 x W14	4	Tighten
O	Nut for steering linkage jam to rod end	M8 x P1.5 x L10 x W14	4	Tighten, inboard LH, outboard RH
P	Hex bolt on front beam pivot	M10 x P1.5 x L25 x H15 x W8	1	Tighten
Q	Nut for front axle	M12 x P1.5 x L12 x W19, nylon lock	2	Snug but allow wheel rotation
R	Hex screw for bottle cage	M4 x P0.8 x L12 x H10 x W4	2	Tighten
S	Hex screw fixing foot platform	M4 x P0.8 x L12 x H10 x W4	14	Tighten
T	Hex screw mounting fender	M4 x P0.8 x L12 x H10 x W4	7	Tighten
U	Hex screw for drop out lock plate	M4 x P0.8 x L12 x H10 x W4	4	Tighten

Figure 2B-1. StreetStrider Eclipse Hardware. Refer to Table 2B-1 for hardware parts letters and descriptions.



### 3. Unpacking and Assembly - A. Eclipse

The Eclipse, the first StreetStrider with a chainless hub, is very simple to assemble - you just have to put the two sections together, then unfold it. To assemble the Eclipse, first view the *StreetStrider Workshop: Eclipse Assembly* video provided on the StreetStrider DVD, then follow the steps and photos in this chapter, which are taken from the assembly video. Included in the Shipping Box are the Eclipse in two sections, the Owner's Manual, Assembly Checklist, StreetStrider DVD, StreetStrider Tool Kit including a 19 mm socket wrench, 12 mm X 15 mm open end wrench, 12 mm X 17 mm open end wrench, hex wrenches – 4, 5, 6 and 8 mm, bottle cage and StreetStrider Velcro wrapping strap.

#### Opening the Box



Figure 3A-1 a, b, c. Opening the box

Open the box with a stout pair of scissors or a knife. NOTE: Do not throw away the box. Inside the box, you will see the front end on top of a cardboard sheet (Fig. 3A-1a). Clip the zip ties from cardboard, lift the front end from the box and set on the ground (Fig. 3A-1b). Lift the other section from the box, set on top of the box (Fig. 3A-1c) and unwrap.

#### Attaching the Front End

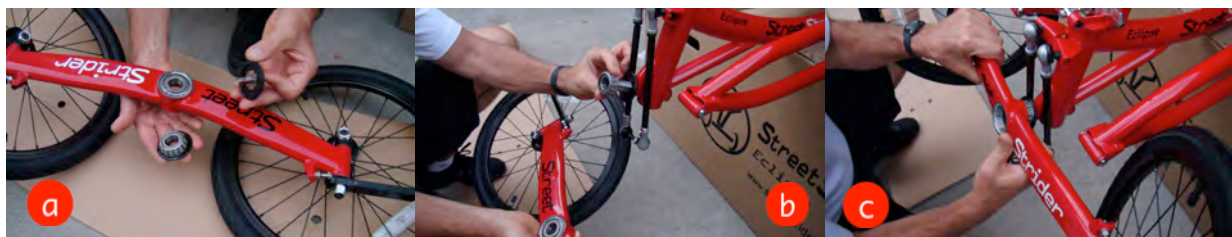

Figure 3A-2 a, b, c. Attaching the front end

The front beam pivot has two sets of tapered roller bearings (Fig. 3A-2a) that fit over the center shaft (Fig. 3A-2b). First place the rear black plate on the shaft, followed by the rear tapered bearing race with the smaller diameter side facing front (Fig. 3A-2b). Next place the beam on the shaft (Fig. 3A-2c), followed by the front bearing race with the smaller diameter end facing rear (Fig. 3A-3a). Finally, insert the center cap screw through the front black cap to secure the front beam assembly (Fig. 3A-3b). Strongly tighten the cap screw with the 8 mm hex wrench from the tool kit (Fig. 3A-3c) until there is no lateral play, making sure the front beam can still rotate around the pivot.



Figure 3A-3 a,b,c. Attaching the front end (con't)

#### Attaching the Outboard Rod Ends

Take the nut off the stud of one outboard rod end using the 10 mm and 12 mm wrenches (Fig. 3A-4a). The base of the stud fits into the recess of the hole on the front end of the black steering arm (Fig. 3A-4b) using proper positioning of the stud flats (Fig. 3A-4c). To secure the stud fitted in the hole, screw the 12 mm nut onto the stud end and tighten (Fig. 3A-5a). Repeat this operation on the other outboard rod end (Fig. 3A-5b). The Eclipse front end is now assembled (Fig. 3A-5c).



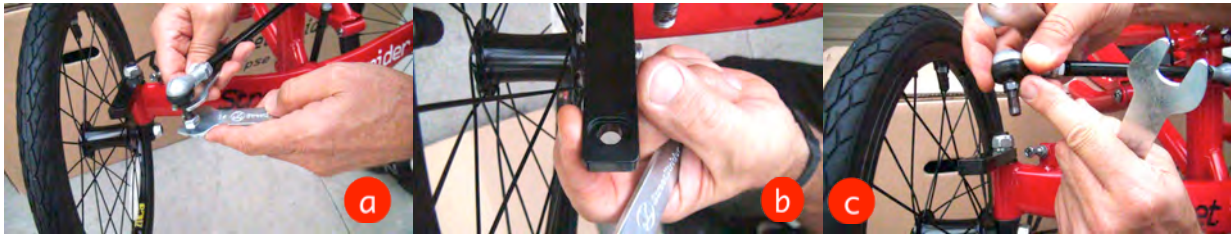

Figure 3A-4 a, b, c. Attaching the outboard rod ends



Figure 3A-5 a, b, c. Attaching the outboard rod ends (con't)

### Attaching the Bottle Cage

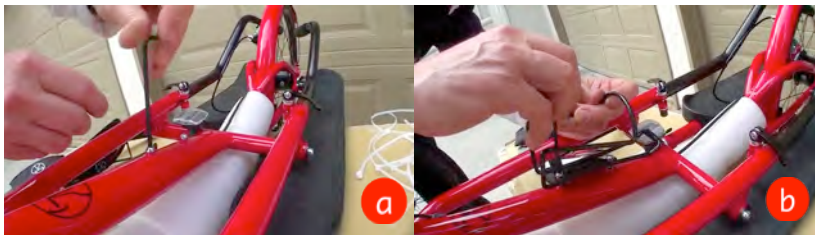

Figure 3A-6 a, b. Attaching the bottle cage

With the 4 mm hex wrench, unscrew the bottle boss screws from the frame (Fig. 3A-6a), retaining the washers. Insert the screws plus washers into their holes in the bottle cage, align them straight into the frame bosses and screw them in (Fig. 3A-6b).

### Unfolding the Head Tube

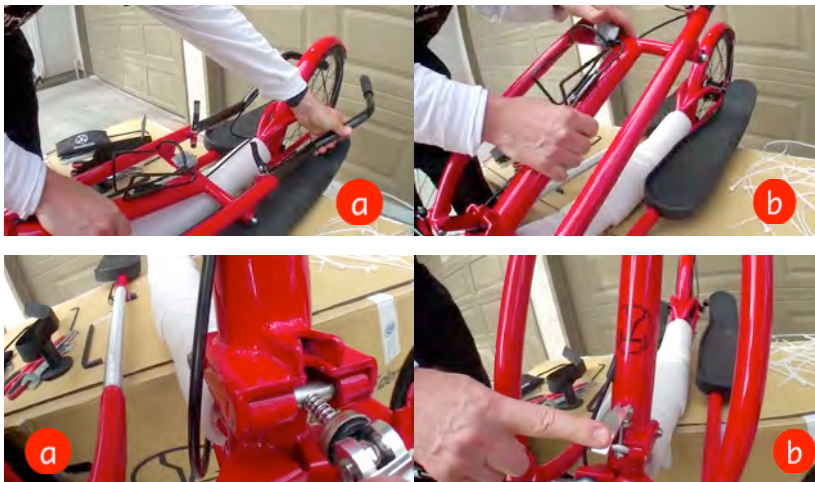

Figure 3A-7 a, b, c, d. Unfolding the head tube

First move the upper strider poles away from the rear wheel by opening the quick release levers on the strider poles, rotating the strider poles (Fig. 3A-7a), then locking the levers. Lift up the head tube (Fig. 3A-7b), then close the quick release joint lever as follows: holding the quick release lever, slide the T-pin all the way to the right (TERMINOLOGY: The right and left sides of the Eclipse refer to the sides when standing on the Eclipse facing forward) edge of the frame (Fig. 3A-7c). Lift up the stem and fit it into the slot on top of the joint with the lever pointed up. Then lock down the lever tightly towards the front (Fig. 3A-7d). NOTE: The serial number is stamped on the head tube under the quick release joint. Record your serial number in this Owner's Manual.

### Collapsing the Telescoping Strider Ski

To collapse the telescoping strider ski, place the Eclipse on the ground (Fig. 3A-8a), then lean it slightly to left side to locate a button on the underside of the strider ski near the quick release lever (Fig. 3A-8b). Open the quick release lever, depress the button, then slide the telescoping tube into the strider ski (Fig. 3A-8c) until the button comes out of the hole near the crank (Fig. 3A-8d), locking the telescoping tube into place. Then tighten the quick release lever.

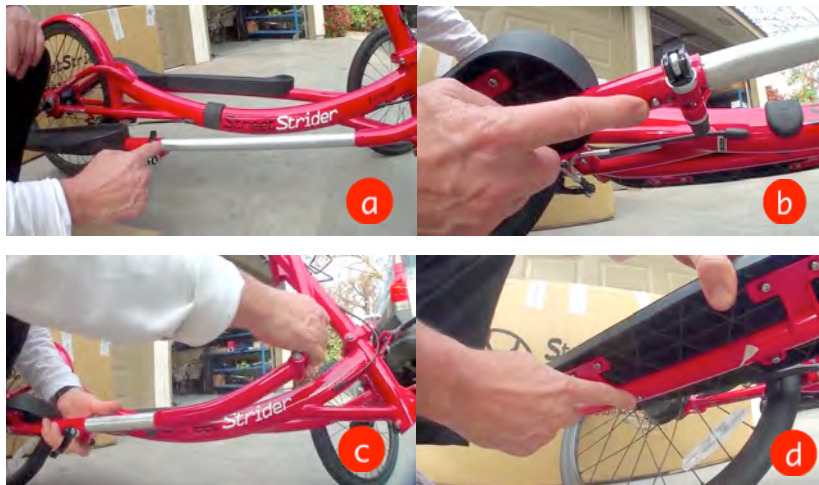

Figure 3A-8 a, b, c, d. Collapsing the telescoping strider ski

**WARNING:** Do not stand on the foot platform when the telescoping strider ski is extended. This action is not covered by the warranty. Doing this will damage or break the telescoping tube, and you will have to purchase a new strider ski. The telescoping tube is extended *only* when folding the Eclipse.

### Adjusting the Strider Poles

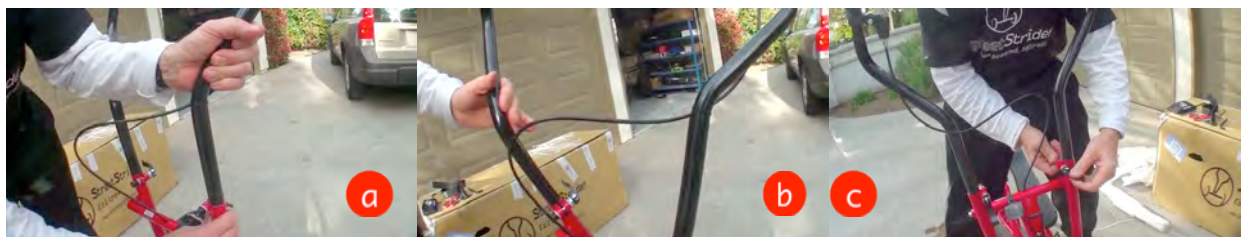

Figure 3A-9 a, b, c. Adjusting the strider poles

The strider poles, also called arm levers, can be adjusted for different heights as well as rotated forward and backward. Open the quick release lever on each strider pole (Fig. 3A-9a) and slide the strider pole up or down. Use the etched indicator marks on the black poles to set them at the same height (Fig. 3A-9b). To make sure the poles are symmetric, put both joints # 2 in the same position by moving the crank arms to the 12 and 6 o'clock position, then rotate the strider poles so they are mirror images (Fig. 3A-9c). The upper section of each pole should be bent slightly forward, away from the rider, for optimum wrist bend. If the upper section is bent slightly backward, towards the rider, then you should reverse the placement of each pole. To do this, raise each pole up and out of the red receiver pole, then place each pole in the opposite red receiver pole. Reposition and lock the quick release levers (Fig. 3A-9c).

### Adjusting Brake Lever Position

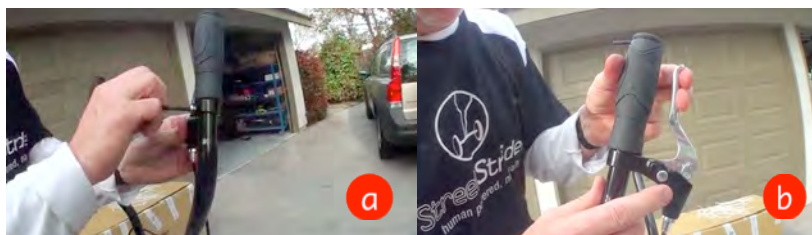

Figure 3A-10 a, b. Adjusting brake lever position

brake pin, push the pin through the hole while squeezing the brake lever. To release the parking brake pin, lightly squeeze the brake lever and the pin will pop out.

To rotate the brake lever to the most comfortable position for your hand to operate the brake lever, use the 5 mm hex wrench from the tool kit. Loosen the screw on the brake lever clamp that is closest to the hand grip (Fig. 3A-10a), rotate the clamp to the correct position, then tighten the screw again. Note the parking brake pin that will prevent the Eclipse from rolling away when parked (Fig. 3A-10b). To engage the parking

### Aligning the Front Wheels

Although the front wheels are aligned at the factory, it is a good idea to check by measuring the distance from mid-tire to mid-tire on the front edge of the front wheels and again on the back edge of the front wheels. If the two distances are equal, the wheels are aligned correctly. If the distances are unequal by more than 1/8" or 3 mm, use the two 14 mm open end wrenches to loosen the rod end jam nuts (Fig. 3A-11a), then rotate the steering rods (Fig. 3A-11b) to adjust the wheels so they are parallel. Check by re-measuring the distances, then tighten the jam nuts with the 14 mm wrenches. The front wheels should remain aligned.



Figure 3A-11 a, b. Aligning the front wheels

### Folding and Unfolding the Eclipse

To fold the Eclipse, rotate the right crank to the 9 o'clock position (Fig. 3A-12a), open the ski quick release, depress the release button and pull the telescoping tube (Fig. 3A-12b) out to the position where the button snaps into the hole (Fig. 3A-12c), then close the ski quick release. Loosen the head tube quick release joint lever, rotate the stem forward, move the T-pin to the left, then fold down the head tube (Fig. 3A-13a). Use the *StreetStrider* Velcro wrapping strap to tightly secure the front frame elements and strider poles together (Fig. 3A-13b). The Eclipse is ready for transportation or for storage.



Figure 3A-12 a, b, c. Folding and unfolding the Eclipse

To unfold the Eclipse, remove the wrapping strap, lift up the head tube, position the quick release lever to clamp down, open the strider ski quick release lever, depress the release button, slide the telescoping tube back into the strider ski and tighten the quick release lever. You're ready to stride (Fig. 3A-13c)!



Figure 3A-13 a, b, c. Folding and unfolding the Eclipse (con't)

## 3. Unpacking and Assembly – B. JET

The JET, the first *StreetStrider* with a chainless hub designed specifically for kids, comes fully assembled - you just have to unwrap it and unfold it. To unfold the JET, first view the *StreetStrider Workshop: JET Assembly* video provided on the DVD, then follow the steps and photos in this chapter, which are taken from the assembly video. Included in the Shipping Box are the JET, folded, with bottle cage and *StreetStrider* Velcro wrapping strap, Owner's Manual, Assembly Checklist, *StreetStrider* DVD, and *StreetStrider* Tool Kit, including 10 mm X 12 mm open end wrench, 10 mm X 14 mm open end wrench, and 4 mm hex wrench.

### Opening the Box

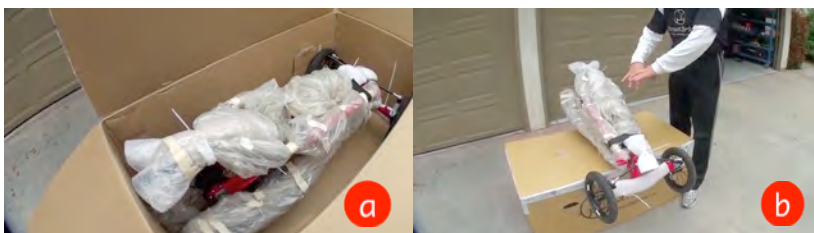

Figure 3B-1 a, b. Opening the box, unwrapping the JET

Open the box with a stout pair of scissors or a knife. NOTE: Do not throw away the box. Remove the wrapped JET from the box (Fig. 3B-1a) and put it on top of the box (Fig. 3B-1b). Unwrap the JET and place it on the ground.

## Unfolding the JET



To unfold the JET, remove the StreetStrider Velcro wrapping strap (Fig. 3B-2a), then lift up the head tube and close the quick release joint lever as follows: holding the quick release lever, slide the T-pin all the way to the right (TERMINOLOGY: The right and left sides of the JET

Figure 3B-2 a, b. Unfolding the JET

refer to the sides when standing on the JET facing forward) edge of the joint frame. Lift up the stem and fit into the slot on top of the joint with the lever pointed up. Then lock down the lever tightly towards front (Fig. 3B-2b).

## Collapsing the Telescoping Strider Ski

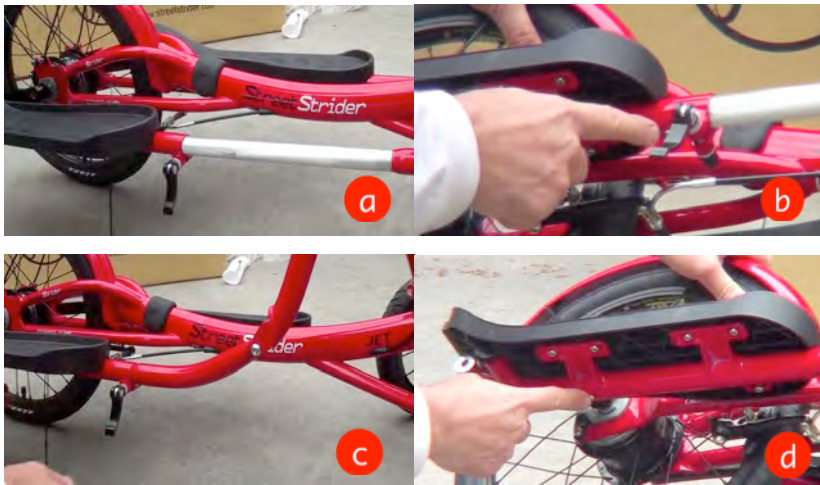

To collapse the telescoping strider ski, first loosen the quick release lever (Fig. 3B-3a). Locate the button beneath the foot platform near the quick release lever (Fig. 3B-3b), depress this button and slide the telescoping tube into the strider ski (Fig. 3B-3c) until the button comes out of the hole near the crank (Fig. 3B-3d), locking the telescoping tube into place. Then tighten the quick release lever.

Figure 3B-3 a, b, c, d. Collapsing the telescoping strider ski

telescoping tube, and you will have to purchase a new strider ski. The telescoping tube is extended *only* when folding the JET.

**WARNING:** Do not stand on the foot platform when the telescoping strider ski is extended. This action is not covered by the warranty. Doing this will damage or break the

## Concerning the Wheels



Figure 3B-4 a, b, c. Concerning the wheels

The two front wheels of the JET are not air-filled so they do not require pumping (Fig. 3B-4a). Although the front wheels are aligned in the factory, it is a good idea to check by measuring the distance from mid-tire to mid-tire on the front edge of the front wheels and again on the back edge of the front wheels. If the two distances are equal, the wheels are aligned correctly. If the distances are unequal by more than 1/8" or 3 mm, use the two 14 mm open end wrenches to loosen the rod end jam nuts (Fig. 3B-4b; see Fig. 3A-10a), then rotate the steering rods with the 4 mm hex wrench inserted into the hole in the linkage to adjust the wheels so they are parallel. Check by re-measuring the distances, then tighten the jam nuts with the 14 mm wrenches. The front wheels should remain aligned. The rear wheel requires pumping through the Schrader valve (Fig. 3B-4c). NOTE: The revolutionary StreetStrider Hartmann hub is chainless (Fig. 3B-4c), with 3.7 to 1 single gear ratio. The chainless hub requires no chain maintenance and has no chain or toothed chain wheel to catch fingers or pants' legs.

**WARNING:** The maximum weight capacity for the JET is 150 lbs or 68 kg. The JET is not made for off road rough use.

## Adjusting the Brake Lever and Strider Poles



Figure 3B-5 a, b, c. Adjusting the brake lever and strider poles

To rotate the brake lever to a normal position, you will need a 5 mm hex wrench (not included). Loosen the brake lever clamp with the hex wrench (Fig. 3B-5a), rotate the brake lever to the preferred position, and tighten the screw.

The strider poles, also called arm levers, can be adjusted for different heights as well as rotated forward and backward. Open the quick release lever on each strider pole and slide the pole up or down (Fig. 3B-5b). Use the etched indicator marks on the black poles to set them at the same height. To make sure the poles are symmetric, put both joints # 2 in the same position by moving the crank arms to the 12 and 6 o'clock position, then rotate the strider poles so they are mirror images (Fig. 3B-5c). Lock each quick release lever.

## Folding the JET for Transport or Storage



Figure 3B-6 a, b, c. Folding the JET for transport or storage

To fold the JET for transport or storage, move the right crank to the 9 o'clock position (Fig. 3B-6a). This will allow you to extend the telescoping tube out of the strider ski. To extend the telescoping tube, loosen the quick release lever, locate and depress the button, grip the tube near the quick release lever and push out with your thumb on the lever (Fig. 3B-6b). The telescoping tube will slide out until the button snaps into the other hole (Fig. 3B-6c), then lock the quick release lever. The two joints #2 are now in the same front position, ready for folding the head tube. To fold the head tube, lift up the front quick release lever, rotate the stem forward, then move the T-pin to the left out of the hole (Fig. 3B-7a), and fold down the head tube. Use the StreetStrider Velcro wrapping strap to tightly secure the front frame and strider poles together (Fig. 3B-7b). The StreetStrider JET is ready to take anywhere (Fig. 3B-7c)!



Figure 3B-7 a, b, c. Folding the JET for transport or storage (cont'd)

## 4. Simple Steps to Learn to Stride

Riding a *StreetStrider* mobile elliptical cross trainer, which feels like a cross between skiing, jogging and cycling, is an absolute blast! Follow these 7 simple steps to learn how to stride:

**Step 1: Safety first.** Before you stride, make sure you have a CPSC (Consumer Product Safety Commission) approved cycling helmet or other helmet to protect your head. Children under 18 years old must wear helmets in some states. If you stride at night, make sure you wear light colored or reflective clothing. It is also advised that you equip your *StreetStrider* with front and rear lights. Before starting any exercise program such as *StreetStriding*, check with your doctor to make sure you are physically healthy enough.

**Step 2: Find a safe, flat place.** An ideal location to first practice your *StreetStriding* is a large flat area such as a parking lot with little to no traffic.

**Step 3: Engage the brake when stepping on the StreetStrider.** Your *StreetStrider* is equipped with a rear brake operated with the right hand grip lever at the top of the strider pole. Each time you step onto your *StreetStrider*, squeeze the brake lever to stabilize the *StreetStrider*.

**Step 4: Step on and get comfortable.** With the brake lever squeezed, step first onto the foot platform that is closest to the ground. Position your foot in about the middle of the platform. You can always change your foot position while striding to find the ideal spot for your striding style.

**Step 5: Lean to steer.** Your *StreetStrider* is equipped with a lean-to-steer system. To make a turn, simply lean a little bit in the direction of the turn and the *StreetStrider* will begin to turn. The more you lean, the more the *StreetStrider* turns. To assist with turning, you may want to lower the foot platform on the inside of the turn. Although this isn't necessary, it can make turning seem easier for some people. Your *StreetStrider* can also be turned by moving both arm strider poles sideways toward the direction of the turn. This movement causes the wheels to turn in that direction.

**Step 6: Cruise a bit.** Before you go out on the road or bike path, it is a good idea to practice using your *StreetStrider* in a safe area. We recommend practicing right and left turns, braking and gear shifting using these instructions.

**Step 7: Have fun.** Now get out there and enjoy your *StreetStrider*! You'll have a blast and burn calories too!

## 5. Safety Equipment

**WARNING:** Many states require specific safety devices. It is your responsibility to familiarize yourself with the laws of the states where you stride and to comply with all applicable laws, including properly equipping yourself and your *StreetStrider* as the law requires.

**Helmets** While not all states require bicyclists to wear approved protective headgear, common sense dictates that you should wear a CPSC (Consumer Product Safety Commission) approved cycling helmet or other helmet whether the law requires it or not. Most serious vehicular injuries involve head injuries that might have been avoided if the rider had worn a helmet. You can find a variety of attractive helmets and get recommendations at the [www.StreetStrider.com](http://www.StreetStrider.com) online store or your local dealer. The "right" helmet is not just a fashion statement. It must fit correctly, be worn correctly and be properly secured to do its real job. Ask *StreetStrider* technical support or your local dealer to help you with the fit and adjustment of your helmet.

**WARNING:** Always wear a helmet when riding your *StreetStrider*. Always keep the chinstrap securely buckled. Failure to wear an approved helmet may result in serious injury or death.

**Reflectors** Reflectors, an integral part of your *StreetStrider*, are important safety devices designed to pick up and reflect street lights and car lights in a way that helps you be seen and recognized as a moving rider. Federal regulations require every *StreetStrider* to be equipped with front and rear wheel and pedal reflectors. The size, performance and location of each reflector are specified by the U.S. Consumer Products Safety Commission. **CAUTION:** Check reflectors and their mounting brackets

regularly to make sure that they are clean, straight, unbroken and securely mounted. Replace damaged reflectors and straighten or tighten any that are bent or loose.

**WARNING:** Do not remove the reflectors or reflector mounting brackets from your *StreetStrider*. They are an integral part of the *StreetStrider*'s safety system. Removing the reflectors may reduce your visibility to others using the roadway. Being struck by other vehicles often results in serious injury or death. Remember - reflectors are not a substitute for lights. Always equip your *StreetStrider* with all state and locally mandated lights.

**Lights** If you ride your *StreetStrider* after dusk, it must be equipped with lights so that you can see the road and avoid road hazards, and so that others can see you. Vehicle laws treat *StreetStriders* like any other vehicles, meaning you must have operating white front and red rear lights if you are riding after dusk. Get lights and recommendations at the [www.StreetStrider.com](http://www.StreetStrider.com) online store or your local dealer.

**WARNING:** Reflectors are not a substitute for proper lights. It is your responsibility to equip your *StreetStrider* with all state and locally mandated lights. Riding at dawn, dusk, night or any other time of poor visibility without a lighting system that meets local and state laws or without reflectors is dangerous and may result in serious injury or death. Front and rear lights are not standard equipment on this *StreetStrider*. If you intend to ride at any time under poor visibility conditions, you must have front and rear lights and reflectors that are adequate for those riding conditions. Lights and reflectors may not be adequate under all conditions to insure that a motorist will see you.

**Eye Protection** It's always a good idea to wear protective eyewear—tinted when the sun is bright, clear when it's not – as any kind of outdoor riding can involve airborne dirt, dust and bugs. Most bicycle shops carry protective eyewear, some with interchangeable lens systems. CAUTION: To avoid injury, always wear suitable protective clothing, including footwear.

**Wet Weather Striding** In wet conditions, the stopping power of all brakes, yours as well as the brakes of other vehicles sharing the road, is dramatically reduced and your tires don't grip nearly as well. This makes it harder to control speed and easier to lose control. To make sure you can slow down and stop safely in wet conditions, ride more slowly and apply your brakes earlier and more gradually than you would under normal, dry conditions.

**WARNING:** Wet weather impairs traction, braking and visibility, both for the *StreetStrider* and for other vehicles sharing the road. The risk of accident is dramatically increased in wet conditions.

**Night Striding** Even if you yourself have excellent night vision, many other people with whom you are sharing the road do not. A *StreetStrider*, like any object, is more difficult for motorists and pedestrians to see at dusk, night, or any other time of poor visibility. Make sure you comply with all local laws about night riding and take the following additional precautions:

- Make sure your *StreetStrider* is equipped with correctly positioned and securely mounted reflectors.
- Purchase and install an adequate battery or generator powered head and tail light.
- Wear light colored, reflective clothing and accessories, such as a reflective vest, reflective arm and leg bands, reflective stripes on your helmet and flashing lights.
- Any reflective device or light source that moves will help you get the attention of approaching motorists, pedestrians and other traffic.
- Make sure your clothing or anything you may be carrying on the *StreetStrider* does not obstruct a reflector or light.
- Stride slowly and avoid areas of heavy traffic, dark areas, and roads with speed limit over 35 mph. Avoid road hazards. If possible, ride on routes already familiar to you.

**WARNING:** *StreetStriding* under poor visibility conditions without reflectors or a lighting system that meets local and state laws can result in serious injury or death.

## 6. Mechanical Safety Check

Here is a simple, sixty-second mechanical safety check that you should get in the habit of making every time you're about to get on a *StreetStrider*. For more details, watch the *StreetStrider Workshop* videos on the Support page of our website [www.streetstrider.com](http://www.streetstrider.com).

**Nuts and Bolts** Lift the rear wheel off the ground by 2-3 inches, then let it bounce on the ground. If anything sounds, feels or looks loose, do a quick visual and tactile inspection of the whole *StreetStrider*. If any loose parts or accessories are found, secure them. If you're not sure, ask someone with experience to check. NOTE: As with any machine, check your Eclipse and JET periodically to make sure all nuts and bolts are tightened.

**Tires and Wheels** NOTE: The two front wheels of the JET are not air-filled and do not require filling. To check if your tires are correctly inflated, check by standing on the platforms with the brake on and then bouncing your weight on the *StreetStrider* while looking at tire deflection. Compare what you see with how it looks when you know the tires are correctly inflated. Add air if necessary. To check if your tires are in good shape, spin each wheel slowly and look for cuts in the tread and sidewall. Replace damaged tires before *StreetStriding*. To check if your wheels are true, spin each wheel - if a wheel wobbles side to side or hits the brake pads, take the *StreetStrider* to a qualified bicycle shop to have the wheel trued. CAUTION: Wheels must be true for the brakes to work effectively. Wheel truing is a skill that requires special tools and experience. Do not attempt to true a wheel unless you have the knowledge and tools needed to do the job correctly.

**Brakes** Squeeze the brake lever. Adjust your brake if the following is true: the brake does not clamp the rear wheel properly, the brake shoes do not contact the wheel rim or hub drum within an inch of brake lever movement, or you cannot apply full braking force at the lever without having it touch the hand grip. Do not ride your *StreetStrider* until the brake is properly adjusted.

**WARNING:** Riding with an improperly adjusted brake or worn brake shoes is dangerous and can result in serious injury or death. Do not attempt to adjust your brake or wheels while the *StreetStrider* is in motion.

**WARNING:** Do not engage in any activity that exceeds your riding ability and skill. Practice new riding skills in a safe controlled environment. Keep hands, fingers and feet away from all moving parts while the *StreetStrider* is in motion, including the tires, wheels, brake and brake cable.

NOTE: Like any sport, *StreetStriding* involves the risk of serious injury, damage and death. By choosing to use a *StreetStrider*, you assume the responsibility for the risk, not the people who sold the *StreetStrider* to you, nor the people who made it, nor the people who distribute it, nor the people who manage or maintain the roads or trails on which you ride. So you need to *know and practice* the rules of safe and responsible *StreetStriding*.

Now buckle on your helmet and enjoy your *StreetStrider*.

## 7. Limited Warranty

The specific warranty covering your *StreetStrider* is governed by the law of the state or country in which it was purchased, and applies only to mobile elliptical devices purchased from a *StreetStrider* Authorized Dealer.

**Frames (Frame, Strider Skis, Strider Poles)** *StreetStrider* frames are warranted by *StreetStrider* International LLC, 204 West Spear Street, Carson City, Nevada 89703, against manufacturing defects in materials and/or workmanship for a period of three years from the date of original purchase.

**Components** Components are warranted by their original manufacturer and not by *StreetStrider* International LLC. The Hartmann Chainless Hub is warranted for a period of one year according to the Sunrace Sturmey Archer warranty: [http://sunrace.com/contact\\_warranty.asp](http://sunrace.com/contact_warranty.asp). Joint bearings, drive parts, frame fixtures and finishes (paint and decals) are warranted against manufacturing defects in materials and/or workmanship for a period of one year and according to the individual components' manufacturers, from the date of the original retail purchase.



**Terms of Limited Warranty** This limited warranty is not meant to suggest or imply that the *StreetStrider* cannot be broken or will last forever. It does mean that the *StreetStrider* is covered subject to the terms of the limited warranty.

- This limited warranty applies only to the original owner of a *StreetStrider* and is not transferable to subsequent owners.
- This limited warranty applies only to *StreetStriders* assembled in full compliance with the instructions within this Owner's Manual.
- Damage resulting from normal wear and tear, including the results of fatigue, is not covered. Fatigue damage is a symptom of the frame being worn out through normal use. It is one kind of normal wear and tear, and it is the owner's responsibility to inspect his/her *StreetStrider* on a regular basis.
- This limited warranty is void if the *StreetStrider* is subjected to abuse, neglect, improper repair, improper maintenance, alteration, modification, an accident or other abnormal, excessive, or improper use – to be determined by the Company at its sole discretion.
- Personal injury, *StreetStrider* failure, loss or damage, abuse, neglect, normal wear and tear including the results of fatigue, improper fit or maintenance by anyone other than a *StreetStrider* Authorized Dealer, or use of parts inconsistent with the use originally intended for the *StreetStrider* as sold are not covered by this warranty. In no event shall the Company be liable for incidental or consequential damages that might arise as a result of improper use and/or failure of the *StreetStrider*.
- For any warranty claim to be considered, the *StreetStrider* must be brought in to a *StreetStrider* Authorized Dealer on the same continent on which the mobile elliptical unit was purchased. The *StreetStrider* must be in assembled condition and accompanied by the original, dated sales receipt for the *StreetStrider*. Be sure to keep your receipt in a safe place.
- All labor and transportation charges for warranty service are the responsibility of the *StreetStrider*'s owner.

During the duration of this limited warranty, the Company will either repair any defective frame or component, or, at our option, replace any defective frame or component with the same or most nearly comparable model or component then available.

THIS IS THE EXCLUSIVE REMEDY UNDER THIS WARRANTY. ANY AND ALL OTHER REMEDIES AND DAMAGES THAT MAY OTHERWISE BE APPLICABLE ARE EXCLUDED, INCLUDING, BUT NOT LIMITED TO, INCIDENTAL OR CONSEQUENTIAL DAMAGES OR PUNITIVE DAMAGES.

THIS IS THE ONLY WARRANTY MADE BY *STREETSTRIDER* ON ITS FRAMES AND COMPONENTS, AND THERE ARE NO WARRANTIES THAT EXTEND BEYOND THE DESCRIPTION HEREIN. ANY WARRANTIES THAT MAY OTHERWISE BE IMPLIED BY LAW INCLUDING, BUT NOT LIMITED TO, ANY IMPLIED WARRANTY OF MERCHANTABILITY OR FITNESS FOR A PARTICULAR PURPOSE, ARE EXCLUDED. Please refer to the documents included with your *StreetStrider* for possible further restrictions.

NOTICE: *StreetStriding* is a potentially hazardous activity, as is bicycling. The user understands that *StreetStriding*, even under normal circumstances, can be hazardous, and accepts full liability for any injury, accident, or death of the user or other *StreetStrider* occupant that may arise from the use of the *StreetStrider*. The user assumes the risk of any personal injury, damage to or failure of the *StreetStrider* and any other losses if the *StreetStrider* is used in any competitive event, including racing, ramp jumping, stunt riding or similar activities or training for such competitive activities or events. This *StreetStrider* is not manufactured, marketed, designed or intended to be altered in any way or at any time for use in the following ways: stunt riding, curb jumping, hopping, or similar activities, in off-road conditions, or with motors, engines or other power equipment. Use of a *StreetStrider* in any of these or similar ways automatically voids the *StreetStrider* Limited Warranty. The Company, its dealers, affiliates or agents shall not be liable under this warranty nor under any state or federal law or the common law or otherwise for any damage, failure, including personal injury, resulting from such use and/or alteration.

This Limited Warranty gives the consumer specific legal rights. The consumer may also have other legal rights that vary from state to state or country to country. Some states and countries do not allow the exclusion or limitation of incidental or consequential damages or warranties, so the above limitations or exclusions may not apply to you. If it is determined by a court of competent jurisdiction that a certain provision of this Limited Warranty does not apply, such determination shall not affect any other provision of this Limited Warranty and all other provisions shall remain in effect.

NOTE: The policy of the Company is one of continued development and improvement. Consequently, we reserve the right to change or amend or discontinue specifications in this publication without prior notice.

## 8. Return Policy

At *StreetStrider International*, our goal is for you to enjoy the benefits of your *StreetStrider* and all products purchased from us for a very long time. However, we offer a 30-day money back guarantee on all *StreetStriders* and products purchased from us in the event that you are unsatisfied for any reason. The 30-day money back guarantee period begins either the day you receive your *StreetStrider* and/or product by the shipping company\* or, if you elected to receive our White Glove Service, the day you picked up your *StreetStrider* from the bike shop.

In order to return a *StreetStrider* and/or product within the 30-day period, please follow these steps:

1. Send an email to us at [returns@streetstrider.com](mailto:returns@streetstrider.com) to request a *Return Merchandise Authorization (RMA) number*. The email must include the following information:
  - a. Original order number
  - b. Original purchaser name, address, and phone number
  - c. Reason for the return
2. We will send the RMA number to you via email.
3. To send the *StreetStrider* and/or product back to us, you must pack it in the original packing material and box. *Care must be taken in packing to prevent damage during shipping.*
4. Place the name of the original purchaser and the RMA number on the box. *No returns will be accepted without the RMA number clearly displayed on the box.*
5. You will be responsible for the cost of shipping the *StreetStrider* and/or product back to us.
6. Send the *StreetStrider* and/or product to:

*StreetStrider*  
5645 W Shaw Ave, Suite 17  
Fresno, CA 93722

When we receive the returned *StreetStrider* and/or product, we will refund your money to you. Your refund will consist of the amount you paid minus the following costs:

1. Cost of shipping the *StreetStrider* and/or product to you
2. A 5% handling/restocking fee
3. An additional fee for repairs *if your StreetStrider and/or product is returned in a damaged condition*
4. White Glove Service fee *if you received free White Glove Service*

\*If your *StreetStrider* is delivered to you in a damaged condition as a result of faulty shipping, please contact us at [shipping@streetstrider.com](mailto:shipping@streetstrider.com) or call 1.775.473.9563 for further instructions. Photographs of the damage are required to make a claim.

Please contact us at [returns@streetstrider.com](mailto:returns@streetstrider.com) or 1.775.473.9563 with any questions.



7042 North West Street, Suite 110, Fresno, CA 93711  
**1.800.348.0998 | [www.StreetStrider.com](http://www.StreetStrider.com)**

© FALL 2011

Like Us On 

[facebook.com/StreetStrider](https://facebook.com/StreetStrider)